

**Shri Narendra Modi**  
Hon'ble Prime Minister

# NEW RAILWAYS NEW DELHI





Desh ko *Gati* rail se  
*Pragati* bhi rail se

---

**Shri Narendra Modi**

Hon'ble Prime Minister

---





## CAPITAL INVESTMENT

- ❖ Investment over rail network in Delhi has increased manyfolds during 2014-24 as compared to the period 2009-14

Average Annual Budget Outlay		
2009 - 14	2014 - 24	% Increase
₹ 96 Cr.	₹ 2477 Cr.	2480%

- ❖ The Average Annual Outlay of Railways in Delhi increased by 2480%

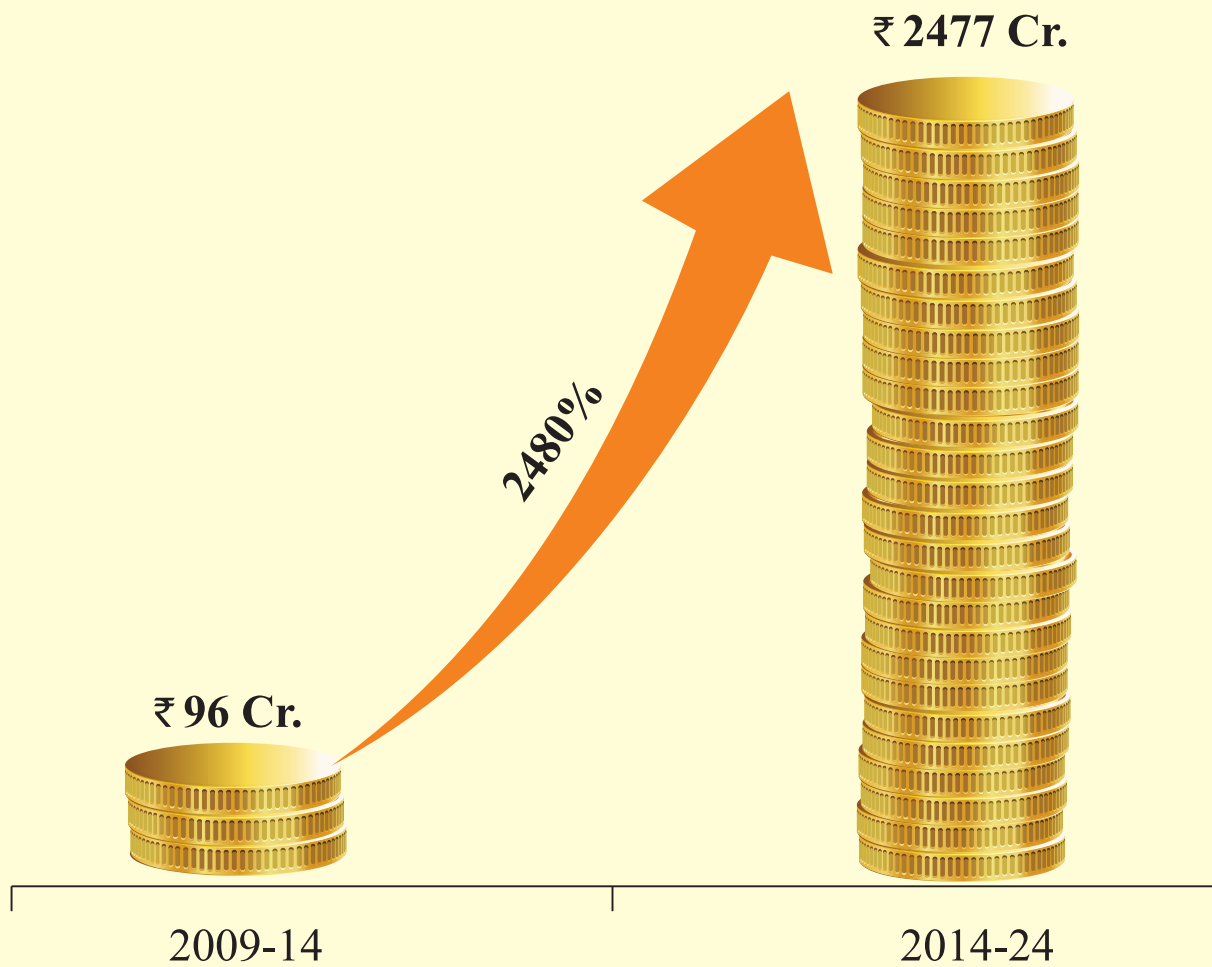



## INFRASTRUCTURE THRUST

- ❖ 5 Projects related to New line/Doubling with an aggregate length of approx. 294 Km at a total cost of ₹ 3,490 Cr.

### NEW LINE PROJECTS

- ❖ Delhi - Sohna - Nuh - Ferozpur - Jhirka - Alwar Section at a cost of ₹ 1,239 Cr.
- ❖ Total length of the line is 104 Km
- ❖ Major stations involved - Delhi, Sohna, Nuh, Ferozpur, Jhirka and Alwar



*Track Relaying Train (TRT)*



## INFRASTRUCTURE THRUST

### Doubling Projects

- ❖ New Delhi - Tilak Bridge - 5th & 6th Line (3 Km) at a cost of ₹ 137 Cr. - completed
- ❖ Daya Basti - Grade Separator (3 Km) at a cost of ₹ 196 Cr.
- ❖ Anand Vihar - Tilak Bridge - 3rd & 4th Line (10 Km) at a cost of ₹ 418 Cr.
- ❖ Delhi - Ghaziabad - Meerut City - Tapri - Saharanpur (Deoband - Tapri) bypass Section (27.66 Km) at a cost of ₹ 1,500 Cr.



*New Line on Delhi - Saharanpur section*



*Daya Basti railway station*



# INFRASTRUCTURE THRUST

## ELECTRIFICATION

### Advantages

- ❖ Faster trains
- ❖ Environment friendly
- ❖ Fuel saving & lower energy costs



Laying Overhead Cables

### During 2014-24

- ❖ 100% Electrification
- ❖ Full Delhi area has been electrified

### Major infrastructure works completed

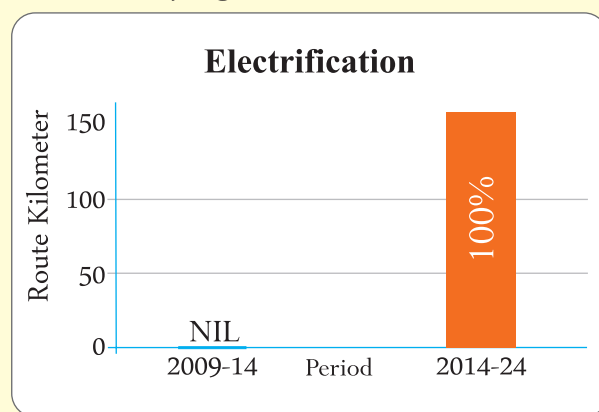

### Advantages

- ❖ Uninterrupted and safe movement of road traffic
- ❖ Improving speed of trains and enhancing passenger safety

### During 2009-14

- ❖ 2 Road Over Bridges (ROBs), 2 Road Under Bridges (RUBs)
- ❖ 1 Foot Over Bridge (FOB) at Hazrat Nizamuddin Railway Station

### During 2014-24

- ❖ 2 Road Over Bridges (ROBs) and 8 Road Under Bridges (RUBs)
- ❖ 3 Road Over Bridges (ROBs) between Badli & Holambi Kalan and Level Crossings at Nangloi & Ghevra
- ❖ Installed Water recycling plant at:-

Stations	Nos. of recycling plant
New Delhi	02
Hazrat Nizamuddin	01
Anand Vihar	01



## CAPACITY ENHANCEMENT

### CONSTRUCTION OF BRIDGES

- ❖ New Bridge over Yamuna River at Delhi being constructed at a cost of ₹ 137 Cr. to ease stress on the existing Lohe Ka Pul
- ❖ 1 no. Water harvesting plant installed at Delhi station



*New Bridge across Yamuna being constructed besides Lohe Ka Pul*

### WORKSHOP

- ❖ Augmentation of Shed Capacity at Ghaziabad from 175 to 200 locomotives, at a cost of ₹ 11 Cr.



*Ghaziabad Loco Shed*



## PASSENGER FOCUS

### INTRODUCTION OF NEW SEMI HIGH SPEED TRAINS

#### **Vande Bharat Express: New Delhi - Varanasi**

- ❖ India's first semi-high speed train set, manufactured indigenously at the Integral Coach Factory (ICF), Chennai in a record time of 18 months, under the Make in India initiative

#### **Vande Bharat Express: New Delhi - Shri Mata Vaishno Devi Katra**

- ❖ Second indigenously developed Semi High Speed Express Train

#### **Vande Bharat Express: Una Himachal - New Delhi**

- ❖ Third indigenously developed Semi High Speed Express Train



*Hon'ble Prime Minister, Shri Narendra Modi flagging-off the Una Himachal – New Delhi Vande Bharat Express Train from Una Himachal railway station*



*Hon'ble PM inspected the train coaches of the Vande Bharat Express at Una - Himachal*



*Hon'ble PM waving to the cheering crowd inside the Vande Bharat Express*





## BHARAT GAURAV TOURIST TRAINS

Indian Railways is all set to run special tourist trains in line with the Government of India initiative “Dekho Apna Desh” and “Ek Bharat Shreshtha Bharat”

- ❖ Bharat Gaurav Tourist Train, an initiative of Indian Railways to promote the “Dekho Apna Desh” and “Ek Bharat Shreshtha Bharat” vision of Govt. of India
- ❖ The State of the Art Deluxe AC Tourist Train has a host of amazing features including two fine dining restaurants, a modern kitchen, shower cubicles etc.
- ❖ In the series of operation of tourist trains on theme based circuits, Indian Railways is now operating Bharat Gaurav Deluxe AC Tourist train to promote pilgrimage tourism in India
- ❖ IRCTC has also tied up with Paytm and Razorpay payment gateways for providing EMI payment option to the customers





## PASSENGER AMENITIES

- ❖ 38 nos. Escalators commissioned at New Delhi, Delhi Jn., H. Nizamuddin, Delhi Sarai Rohilla etc.
- ❖ 31 nos. Lifts commissioned at New Delhi, Delhi Jn., H. Nizamuddin, Delhi Sarai Rohilla etc.

## REDEVELOPMENT OF STATIONS



*Proposed building of Narela Railway Station*

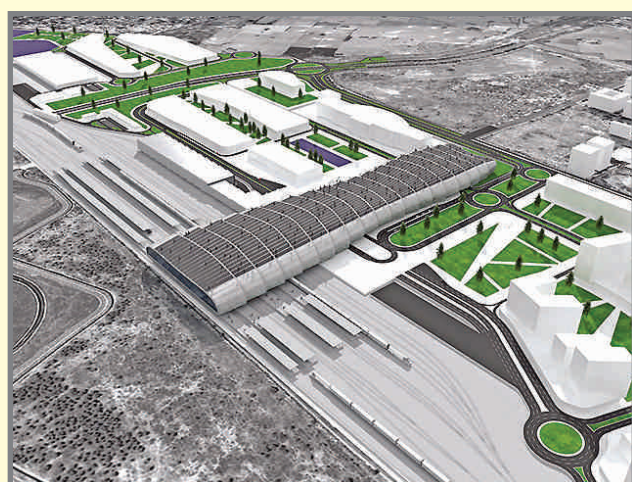

*Bijwasan railway station  
Master Plan*



*Proposed building of Delhi Safdarjung  
Railway Station*



## PASSENGER AMENITIES

- ❖ 13 Nos CCTV installed at Parcel office at Anand Vihar Terminal (08 Nos), Muzaffarnagar (01 No) and Meerut City (04 Nos)
- ❖ 02 Nos Bullet type CCTV cameras has been installed at CCRS TA building. 02 nos. CCTV has been provided at Nangloi booking office
- ❖ Train Information Display Board installed at Bahadurgarh & Delhi Kishanganj station
- ❖ Coach Display System installed at Delhi Kishanganj & Subzi Mandi station
- ❖ 2 nos. Escalator at PF 16 New Delhi station
- ❖ 2 nos. FOB commissioned at Patel Nagar & Adarsh Nagar stations
- ❖ Platform surface renovated at Pragati Maidan, Subzi Mandi & Tilak Bridge stations
- ❖ One Station One Product scheme announced in Union Budget 2022-23 is in line with the Government of India's 'Vocal for Local' vision. A total of 21 Outlets have been installed over Delhi (Hazrat Nizamuddin, Delhi Shahdara, Delhi Cantt., Delhi Jn., Subzi Mandi, Shakurbasti, Badli, Shivaji Bridge, Anand Vihar Terminal, Delhi Sarai Rohilla, Delhi Azadpur, Vivek Vihar, Mangolpuri, Delhi Safdarjng, Okhla, Delhi Kishanganj, Tilak Bridge, Palam, Tughlakabad, Narela, Nangloi) area. It creates additional income opportunities/ better livelihood conditions to local beneficiaries i.e. Local Artisans, potters, Weavers/ Handlooms etc. during the period of April 2023 to June 2024
- ❖ Pradhan Mantri Bhartiya Jan Aushadhi Kendra (PMBJK) stores have been set up at Anand Vihar station to provide generic drugs, which are available at lesser prices but are equivalent in quality and efficacy as expensive branded drugs
- ❖ Braille Signage installed for visually impaired people under CSR at 6 (Delhi Jn., New Delhi, Hazrat Nizamuddin, Delhi Sarai Rohilla, Delhi Shahdara, Delhi Cantt.) railway stations to enable them to commute with ease and with minimal help from others.
- ❖ E sahayak desk has been set up to at 2 major stations (New Delhi and Hazrat Nizamuddin) under CSR to assist Divyangjans as single source of information as a part of Sugamya Bharat Abhiyan or Accessible India campaign of GOI. Delhi Division is first in Indian Railways to implement this project
- ❖ 2 nos. 150 LPH Water coolers have been provided at Subzi Mandi Railway station



## PASSENGER AMENITIES

- ❖ New construction, repairs and extension of Foot Over Bridges (FOBs) at New Delhi, Delhi Jn., Delhi Cantt., Delhi Sarai Rohilla, H. Nizamuddin, Khalilpur and Ichhapuri railway stations
- ❖ Renovation of parking cum circulating area at Nangloi, Delhi Jn. (2nd entry), H. Nizamuddin, Shakurbasti, Delhi Sarai Rohilla, Narela and Badli railway stations
- ❖ Renovation of platform surface at Delhi Shahdara, Patel Nagar, Adarsh Nagar, Anand Vihar, Delhi Sarai Rohilla, Delhi Kishanganj, Dayabasti, Narela, Badli, Shakurbasti and Delhi Shahdara railway stations
- ❖ Construction of Platform sheds at Delhi Sarai Rohilla, Delhi Cantt and Delhi Adarsh Nagar etc. New FOB commissioned at H. Nizamuddin during 2022-23
- ❖ Provision of 957 chairs at Delhi Jn., New Delhi, Adarsh Nagar Delhi, Delhi Kishanganj, Sabji Mandi, Delhi Shahdara, Delhi Cantt. and Anand Vihar railway stations under MPLAD scheme.
- ❖ 54 Nos. CCTV cameras (32 Nos - New Delhi, 6 Nos - Delhi Jn. & 16 Nos. H. Nizamuddin) have been installed at escalators of stations for security purpose
- ❖ GPS clocks have been provided at Delhi Sadar Bazar, Brar Square, Bijwasan, Holambi Kalan, Lajpat Nagar, Sarojni Nagar and Sewa Nagar stations



*Inauguration of newly constructed Foot Over Bridge (FOB) at Harkesh Nagar, New Delhi by Hon'ble Former Minister of State for Railways, Shri Manoj Sinha and MP, Shri Ramesh Bidhuri*



## FREIGHT OPERATIONS

- ❖ Development of New Terminal Building at a cost of ₹152 Cr. and New Coaching Terminal Phase-II at Anand Vihar at a cost of ₹126 Cr.
- ❖ Land Acquisition for development of Freight and Coaching Terminal at Bijwasan at a cost of ₹226 Cr.
- ❖ Coaching/freight handling terminal at Bijwasan at a cost of ₹92 Cr.
- ❖ Acquisition of land and development of world class Freight Terminal at Holambi Kalan at a cost of ₹125 Cr.
- ❖ Coaching Terminal at Shakurbasti at a cost of ₹111 Cr.
- ❖ Development of additional train handling facilities at Tilak Bridge, Subzi Mandi, Sarai Rohilla, Shakurbasti, Ghaziabad, H. Nizamuddin and Tuglakabad at a cost of ₹120 Cr.



*Freight Terminal*



## DIGITAL INDIA



### FAST & FREE Wi-Fi

- ❖ To boost Digital India Initiative, Wi-Fi facility provided at H. Nizamuddin, Anand Vihar Terminal, New Delhi, Delhi Jn., Delhi Shahdara, Delhi Cantt., Delhi Sarai Rohilla, Adarsh Nagar Delhi and Ghevra railway stations

### DIGITAL TRANSACTIONS

- ❖ Provision of 20 Point of Sale (PoS) Machines
- ❖ Cashless transactions can be made through BHIM, RuPay, Debit card, e-wallets etc. at ticket counters



*Point of Sale (PoS) machine for cashless transaction at PRS*



## SWACHH RAIL, SWACHH BHARAT

- ❖ Launch of 'Rail Madad' app
- ❖ Provision of clean Bedrolls in all nominated trains.
- ❖ Upgradation of all NR based Rajdhani and Shatabdi coaches with enhanced passenger amenities under 'Project Swarn'
- ❖ Upgradation of all eligible NR based ICF coaches with enhanced passenger amenities under 'Project Utkrisht'
- ❖ To commemorate the 75th year of India's Independence, "Azadi Ka Amrit Mahotsav" is being celebrated across the country. In this context, two trains viz. T.No. 12954 August Kranti Express & T.No. 15274 Satyagraha Express were flagged-off by freedom fighters/their families under the theme of "Azadi Ki Rail Gadi aur Stations". Historical facts about these trains were depicted through heritage photo exhibition organized at Hazrat Nizamuddin & Anand Vihar.



*NZM: T.No. 12954 (August Kranti Express)*

- ❖ Provision of 05 nos. Automatic Coach Washing Plants at New Delhi (Rajdhani complex & DLT complex), Hazrat Nizamuddin, Delhi Sarai Rohilla & Anand Vihar for external washing of coaches



*Automatic Coach Washing Plant at DLT complex, New Delhi*



## GREEN INITIATIVES

### During 2009-14

- ❖ Harnessing solar energy
  - 10 kWp solar modules provided
- ❖ LED lights
  - Nil



*Coach with Rooftop Solar Panel*

### During 2014-24

- ❖ Harnessing solar energy
  - Provision of 362 kWp solar modules
  - Commissioning of 6.4 MWp Solar plant on PPP basis at cost of ₹ 4.15 unit at New Delhi, Hazrat Nizamuddin, Anand Vihar, Delhi Jn., Delhi Cantt, Delhi Sarai Rohilla, Delhi Shahdara and Tugalkabad
  - Annual saving of 81 Lakhs units amounting to ₹ 517 Lakh
  - Reduction in CO<sub>2</sub> emission by 7,225 Ton
- ❖ Solar plant/Solar panel provided at 08 stations and 10 service buildings
- ❖ Provision of LED lights across all 14 stations in Delhi Area for energy conservation (100% coverage)
- ❖ An innovative contract for waste management and resource recovery has been awarded at 30 stations of Delhi area, fetching Non-Fare Revenue (NFR) of about ₹ 5 million for 5 years for segregating the waste into wet and dry waste and ensuring treatment of all wet waste by composting

#### Average Solar Power Generation per year

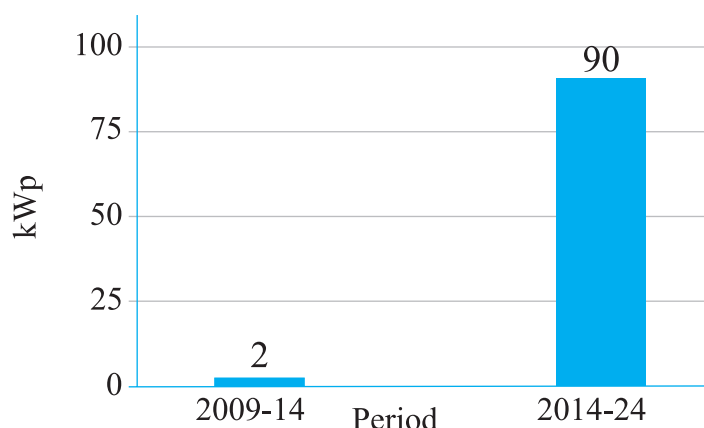





## COVID-19: PASSENGER FOCUS

### Shramik Special Trains

- ❖ Operation of 254 Shramik Specials trains during the Covid-19 lockdown enabling migrant workers, pilgrims, tourists, students and other people to reach their homes



### Special Passenger Trains

- ❖ Operation of 132 Mail / Express, Rajdhani Special and Workman Special Trains from Delhi Area





## COVID-19: INNOVATIVE USE OF ASSETS

### Production of PPE Kits, Masks and sanitizer

- ❖ Jagadhari Workshop developed a WHO standard PPE kits approved by DRDE Gwalior
- ❖ More than 90,000 PPE kits have been manufactured at half the market price to support the healthcare workers and frontline staff
- ❖ 834 litre sanitizer produced in-house for mass distribution
- ❖ Installation of 75 hands-free washbasins
- ❖ 50 contactless soap/sanitizer dispensers made
- ❖ Development of touchless temperature measuring devices



### Isolation Coaches

Unique bid to create additional quarantine facilities to bolster country's healthcare infrastructure to tackle Covid-19 Pandemic

- ❖ Conversion of Mobile Non AC rail coaches to isolation wards
- ❖ Cost-effective interim medical facility for semi-urban and rural areas
- ❖ 16 patients can be accommodated per coach
- ❖ Indian style toilet on one side converted to bathroom
- ❖ Arrangement of separate space for paramedics
- ❖ Each compartment provided with additional electric ports and fans
- ❖ Provision of oxygen cylinders





## COVID-19: HEALTHCARE

### Conversion of Coaches into Covid Care Centres

- ❖ 503 isolation coaches placed in Delhi Area
- ❖ Interim Healthcare facility
- ❖ 8048 beds available for Covid patients
- ❖ Coaches acting as an extension of Covid care hospitals
- ❖ Provision of wholesome nutritious meals by Indian Railways





## COVID-19: HEALTHCARE

### Shakurbasti Covid Care Centre

- ❖ 50 isolation coaches placed at Shakurbasti railway station
- ❖ 590 persons admitted for treatment
- ❖ Provision of wholesome meals three times a day
- ❖ Alarm system installed in all coaches

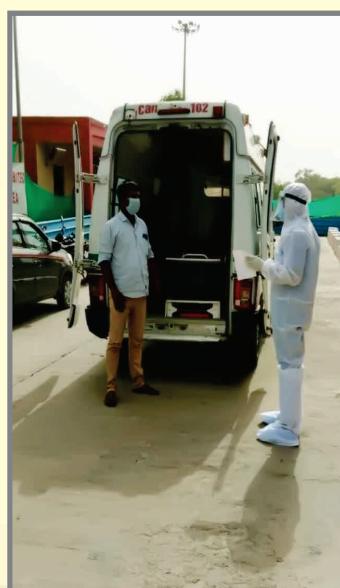



## COVID-19: FREIGHT OPERATIONS

### Freight Trains

- ❖ Registered freight loading of 33.40 Million Tonnes
- ❖ Movement of 18.74 Million Tonnes foodgrain to different states for distribution through PDS ration shops
- ❖ Constitution of long haul 5000 Tonne Jumbo trains - Annapurna, Amba and Antyodaya
- ❖ Operation of time tabled Parcel and Freight trains for delivery of essential goods
- ❖ Special milk train 'Doodh Duranto' from Andhra Pradesh
- ❖ Operation of 24 Parcel Cargo Express trains to various destinations
- ❖ A 24 tonne parcel van leased to e-commerce major Amazon for movement of consignment to Bangalore
- ❖ Revenue generation of ₹3.46 Cr. through movement of e-commerce consignment



*'Doodh Duranto' milk train*

### Freight Business Development Units (BDU)

- ❖ BDU's set up at zonal and divisional levels for increasing freight business of Railways
- ❖ 44 Goods Sheds identified for upgradation
- ❖ 'Vyapar Mala', first ever special express train for piecemeal freight operated from Guniana - Delhi
- ❖ Kishanganj - Jiribam (Tripura), earned over ₹ 94 lakh from this BDU initiative
- ❖ Time tabled, Efficient and Economically Viable Railway Services (TEEVRA) operated for provision of customized transportation solutions to medium and small businesses
- ❖ Digitalization of processes for ease of doing business

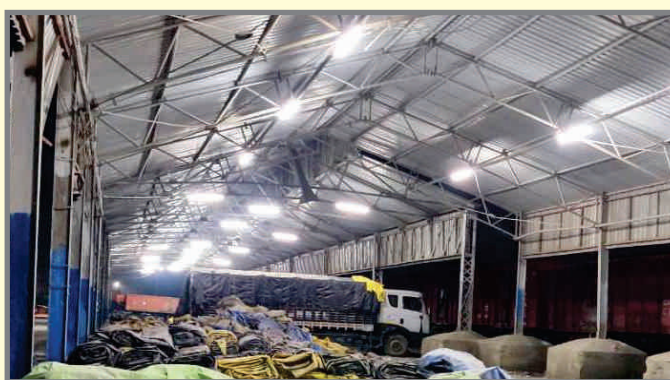

*Providing enhanced facilities at goods sheds*



## COVID-19: INFRASTRUCTURE THRUST

### Increase in Sectional Speed

- ❖ New Delhi - Ghaziabad - Chipiyana Buzurg section (from 110 Kmph to 130 Kmph)
- ❖ New Delhi - Tuglakabad section (from 120Kmph to 130Kmph)
- ❖ Delhi Jn. - Sahibabad section (from 100 Kmph to 110 Kmph)
- ❖ Narwana - Kurukshetra section (from 65 Kmph to 110 Kmph)
- ❖ Rewari - Asthal Bohar section (from 100 Kmph to 110 Kmph)
- ❖ Delhi Shadhara - Tapri section (from 100 Kmph to 110 Kmph)



### Maintenance of Electric Traction

- ❖ Maintenance of 4572 Km Electrified Track OHE system
- ❖ Replacement of 1.47 Km over-aged and weak catenary wire





## SHOWCASING OUR HERITAGE



*Hon'ble Former Minister of State for Railways, Shri Rajen Gohain participating in the Heritage Run of Fairy Queen, the oldest running steam locomotive in India on 26<sup>th</sup> January, 2018*

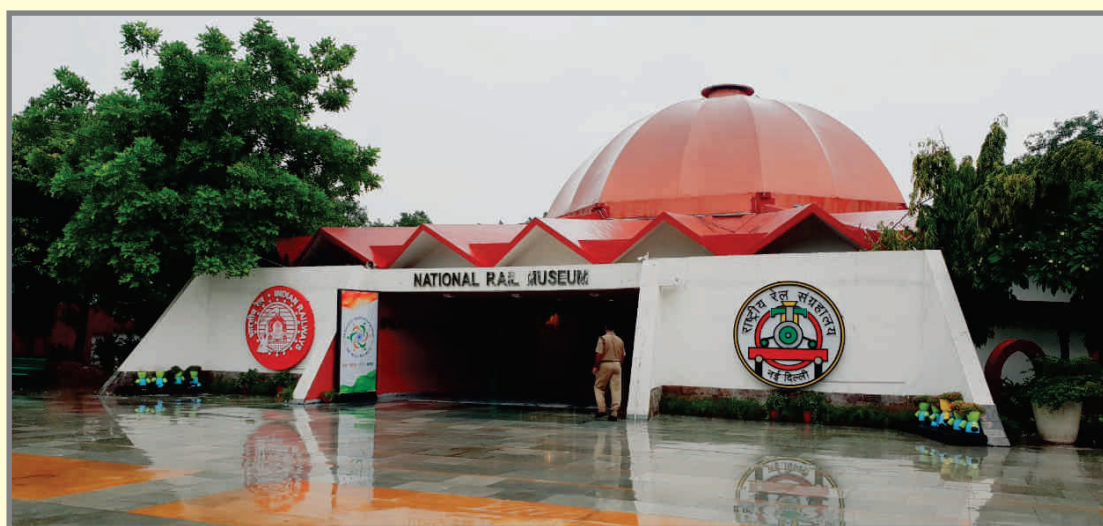

*National Rail Museum, New Delhi*



*'Azad' heritage steam locomotive*

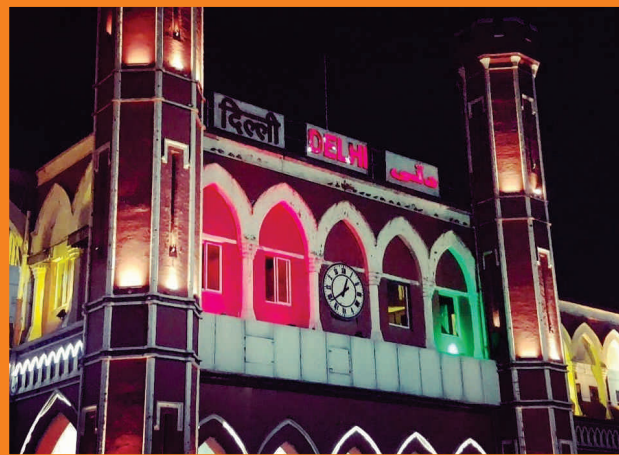





## COVID-19: INFRASTRUCTURE THRUST



*Track Monitoring & Repair*



*Use of state-of-art UNIMAT and Tamping Machines for renovation of tracks*



*Rehabilitation of Bridges*



## ONGOING INFRASTRUCTURE WORKS

- ❖ 1 Foot over bridge at the cost of 2.49 Cr. at Nangloi station

### New Works Section in Budget 2023-24

- ❖ 4 Foot Over Bridge at the cost 16.36 Cr. at Adarsh Nagar, Inder Puri, Hazrat Nizamuddin stations (2 Nos.)
- ❖ 3 Passenger amenities works at the cost 22.5 Cr. at Subzi Mandi, Narela stations

### Status of Important Passenger Amenities as on 31.03.2023

- ❖ 4 Adarsh stations ❖ 14 Divyang Toilets at New Delhi, Delhi Jn., Hazrat Nizamuddin, Subzi Mandi, Tilak Bridge, Narela & Okhla stations
- ❖ 14 CCTV ❖ 31 Wi-Fi

### Station Redevelopment Projects

Delhi Cantt., Bijwasan, Delhi Safdarjung, New Delhi, Adarsh Nagar Delhi, Anand Vihar, Delhi Sarai Rohilla, Delhi Shahadra, Delhi Junction and Hazrat Nizamuddin

### Amrit Bharat Stations

Narela, Subzi Mandi and Tilak Bridge



*Babasaheb Ambedkar Yatra Bharat Gaurav Tourist Train*

